

Down the River
from the Chesnut
to the Post.

- N 40 E 60
 - N 55 E 25
 - N 63 E 41
 - N 76 E 56
 - N 86 E 33
 - S 77 E 48
 - S 68 E 40
 - S 77 E 36
 - S 61 E 32
- 377 Perches

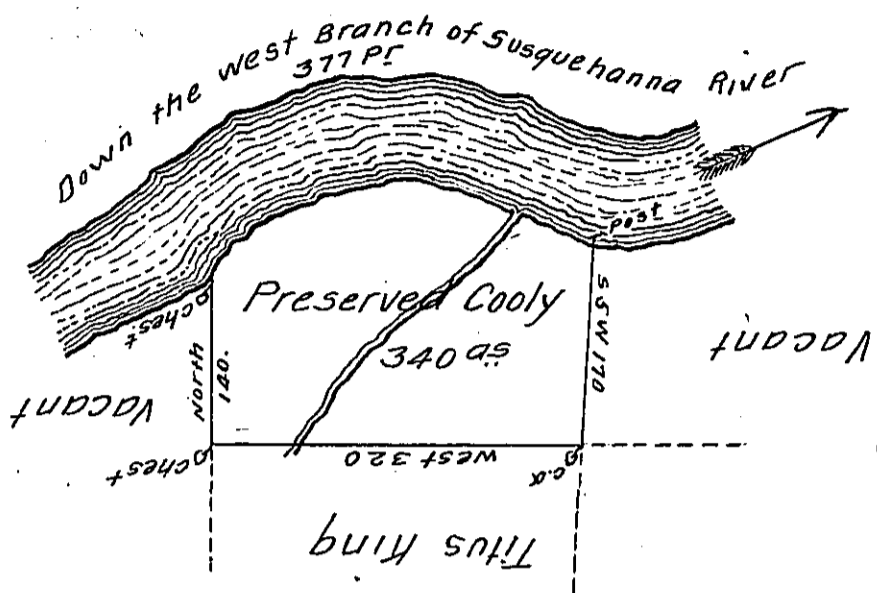

(obl.) South side of the west Branch of Susquehanna About (obl.)
 er the Great Island in Bald Eagle Township (obl.) County formerly
 Northumberland. Survey'd on the (obl.) ¹⁷⁹⁷ for Preserved Cooly by
 Virtue of his Order from (obl.) al Assembly of the State of Penns-
 ylvania (obl.) ate on the 30 Day of January 1784. Containing (obl.)
 ndred and forty Acres and the usual Allowance (obl.) &c.

To Daniel Brodhead Esq^r } Henry Donnel D. S.
 Surveyor General }

IN TESTIMONY that the above is a copy of the original remaining on file in
 the Department of Internal Affairs of Pennsylvania, made
 conformably to an Act of Assembly approved the 16th day of
 February, 1833, I have hereunto set my Hand and caused
 the Seal of said Department to be affixed at Harrisburg,
 this first day of November 1910.

Henry Houck
 Secretary of Internal Affairs.